



## INDIVIDUAL OFFICES FOR LEASE

### LEASE OVERVIEW

**AVAILABLE | OFFICE 6 & 8**

**LEASE PRICE | \$800 PER OFFICE**

**OFFICE SIZE | 140-185 +/- SF EACH**

**LEASE TYPE | GROSS**

**ZONING | CB & RM-1 &  
DOWNTOWN OVERLAY**

Great opportunity to lease an individual professional office in downtown Southern Pines. Located on the corner of E Pennsylvania Avenue and N Ashe Street and within walking distance to all restaurants, retail, and the post office. The multi-tenanted property offers plenty of on-site parking, and a shared reception area, conference room, and kitchenette. Two individual offices available to lease. Utilities included. Wireless Internet an additional \$35 per month.

**HOLLY BELL**  
NC BROKER  
C: 910.690.1065  
HOLLY@CSGNC.COM

**CAROLINA SUMMIT GROUP**  
115 W Pennsylvania Ave.  
Southern Pines, NC 28387  
910.684.5353  
carolinasummitgroup.com

**GEORGE MANLEY**  
NC BROKER  
C: 910.603.8395  
GEORGE@CSGNC.COM

**PHOTOS**



**Front of Building**



**Main Entrance**



**Shared Reception**

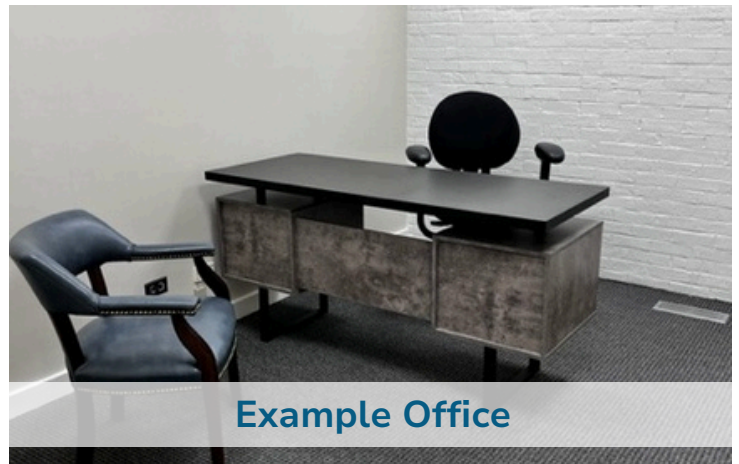

**Example Office**



**Shared Kitchenette**



**Shared Conference Room**

**HOLLY BELL**  
NC BROKER  
C: 910.690.1065  
HOLLY@CSGNC.COM

**CAROLINA SUMMIT GROUP**  
115 W Pennsylvania Ave.  
Southern Pines, NC 28387  
910.684.5353  
carolinasummitgroup.com

**GEORGE MANLEY**  
NC BROKER  
C: 910.603.8395  
GEORGE@CSGNC.COM

**BUILDING LAYOUT**

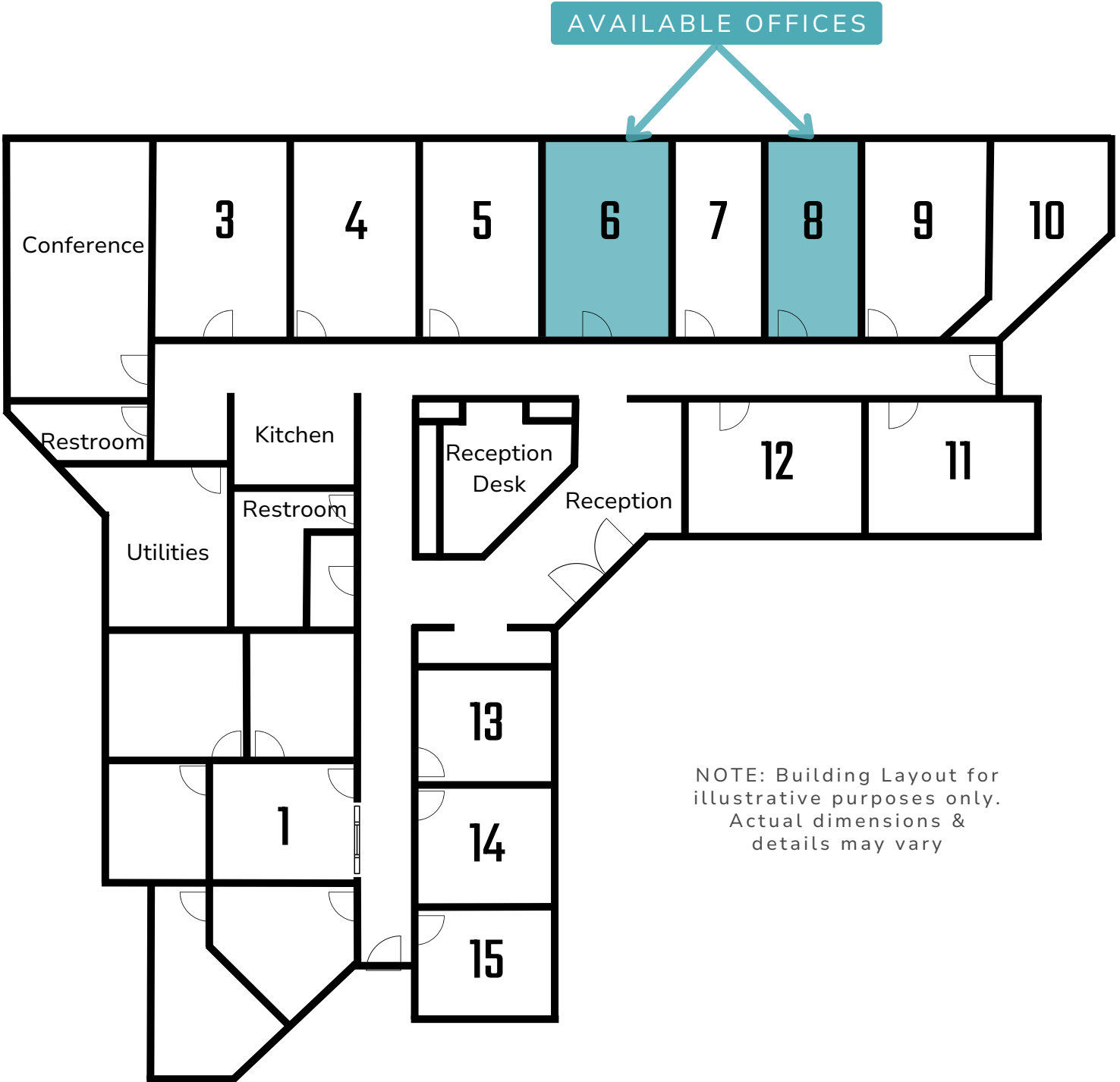

NOTE: Building Layout for illustrative purposes only. Actual dimensions & details may vary

**RETAIL MAP**

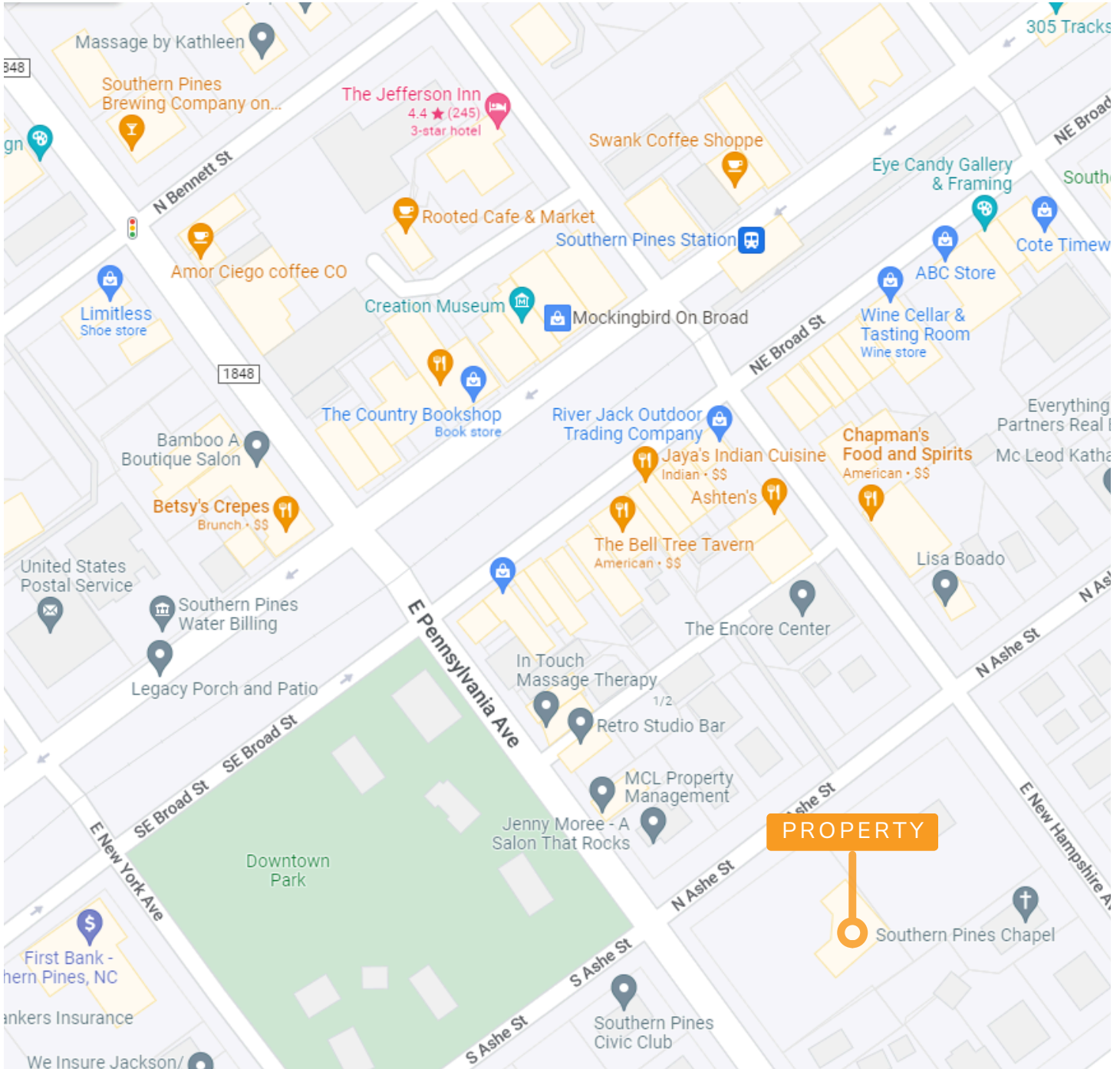

**HOLLY BELL**  
NC BROKER  
C: 910.690.1065  
HOLLY@CSGNC.COM

**CAROLINA SUMMIT GROUP**  
115 W Pennsylvania Ave.  
Southern Pines, NC 28387  
910.684.5353  
carolinasmittgroup.com

**GEORGE MANLEY**  
NC BROKER  
C: 910.603.8395  
GEORGE@CSGNC.COM

**LOCATION MAP**

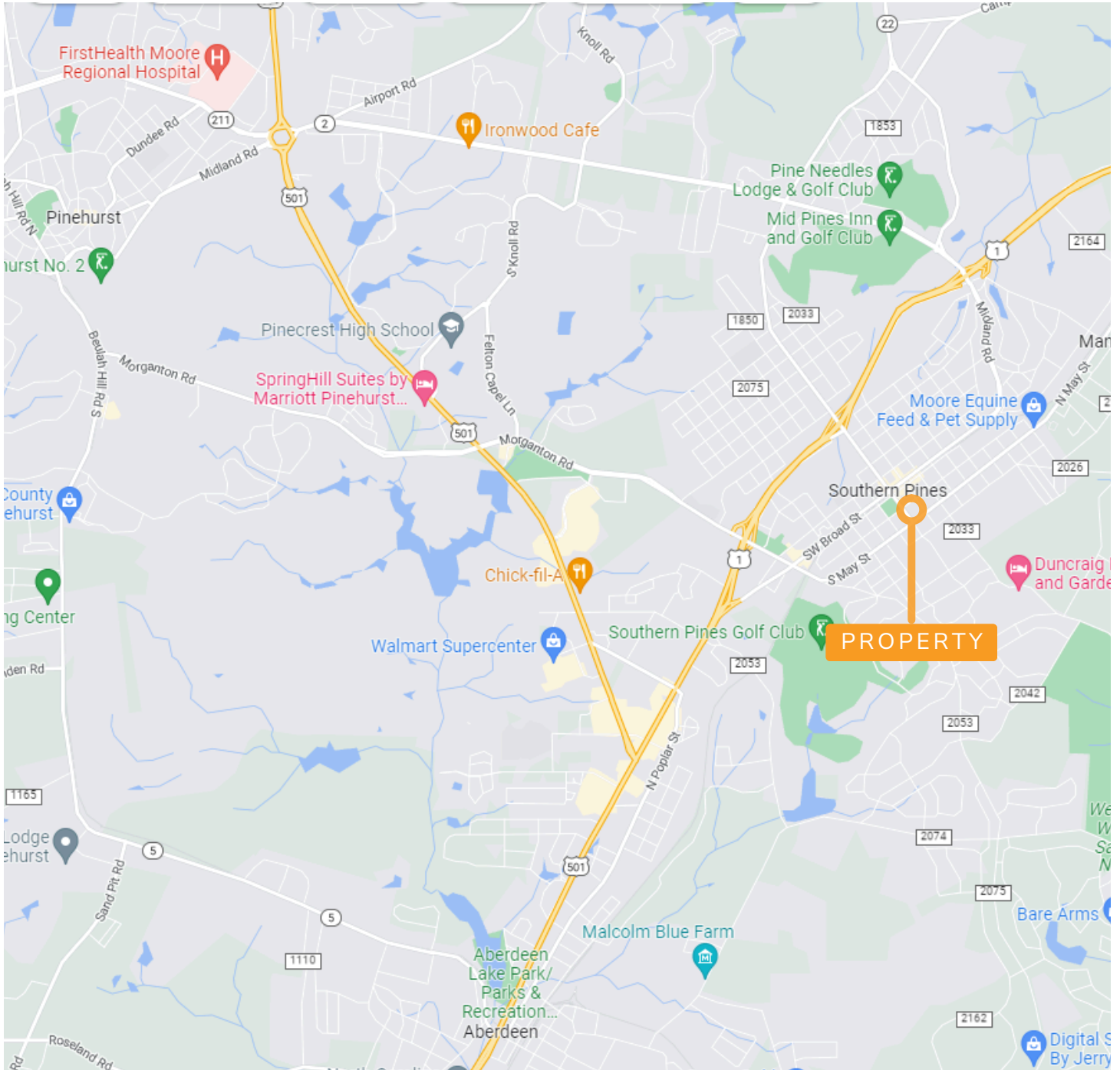

**HOLLY BELL**  
NC BROKER  
C: 910.690.1065  
HOLLY@CSGNC.COM

**CAROLINA SUMMIT GROUP**  
115 W Pennsylvania Ave.  
Southern Pines , NC 28387  
910.684.5353  
carolinasummitgroup.com

**GEORGE MANLEY**  
NC BROKER  
C: 910.603.8395  
GEORGE@CSGNC.COM